

REGISTERED ARCHITECT'S CERTIFICATE

STATE OF HAWAII)
) ss.
CITY AND COUNTY OF HONOLULU)

KAULU II
CONDO MAP 6603
Recorded 6/18/24

The undersigned, **JACOB E. KARASIK** states as follows:

That he is an architect registered with the State of Hawaii, Hawaii Registration No. A-19861;

That the floor and elevation plans of single family detached buildings and multi-family attached buildings in the **Ka'ulu by Gentry II** condominium project depict the layout, location, unit numbers and dimensions of the condominium units comprising said buildings and are hereby certified to be consistent with the plans of the condominium's buildings to be filed with the officer of the City and County of Honolulu having jurisdiction over the issuance of permits for the construction of buildings; and

That, including the site plan, there are a total of thirty-nine (39) sheets which constitute the condominium map for **Ka'ulu by Gentry II**.



JACOB E. KARASIK

STATE OF HAWAII)
) SS.
CITY AND COUNTY OF HONOLULU)

On April 18, 2024, before me appeared **JACOB E. KARASIK**, to me personally known, who, being by me duly sworn or affirmed, did say that such person executed the foregoing instrument as the free act and deed of such person and if applicable in the capacity shown, having been duly authorized to execute such instrument in such capacity.

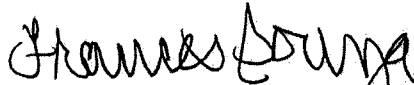

Notary Public, State of Hawaii

Printed Name of Notary: Frances Souza
My commission expires: November 20, 2024

Doc Dated: Undated # Pages: 1

Name: Frances Souza First Circuit

Doc. Description: Registered Architect's Certificate

My Commission Expires: November 20, 2024

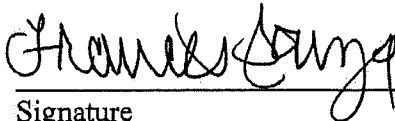

Signature

April 18, 2024
Date

NOTARY CERTIFICATION

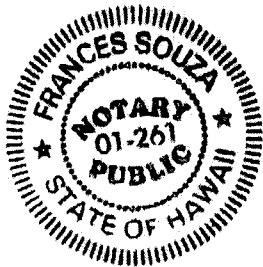
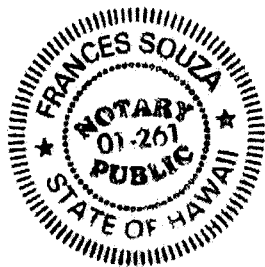

KA'ULU BY GENTRY II

91-1101 FRANKLIN D. ROOSEVELT AVENUE,
KAPOLEI, HAWAII 96707

KA'ULU BY GENTRY I
EXISTING

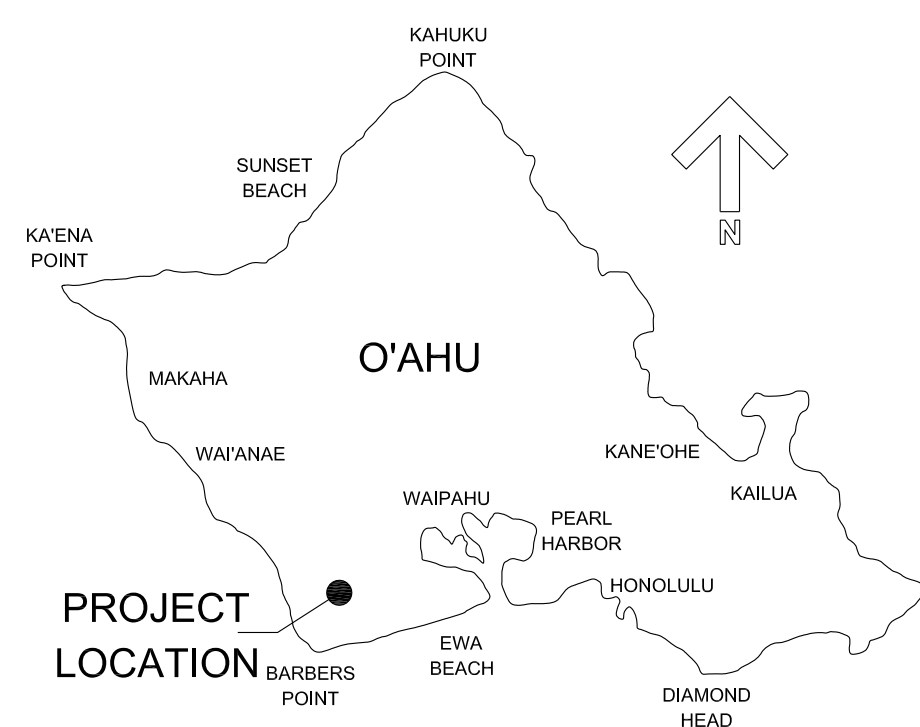

3
T-1 VICINITY MAP
NOT TO SCALE

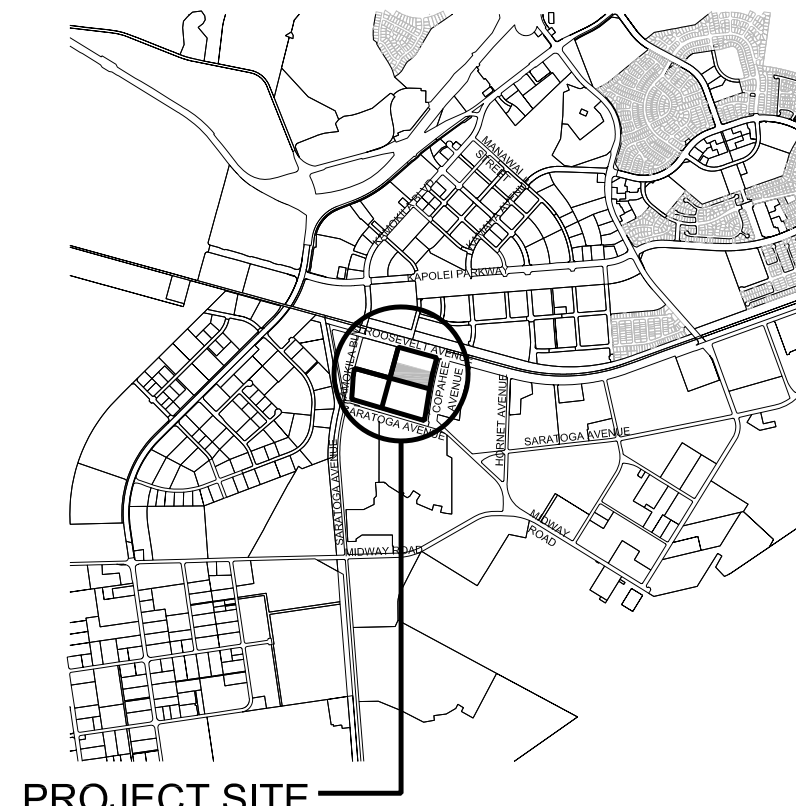

2
T-1 LOCATION MAP
NOT TO SCALE

VA CENTER
(NOT PART OF KA'ULU BY GENTRY)

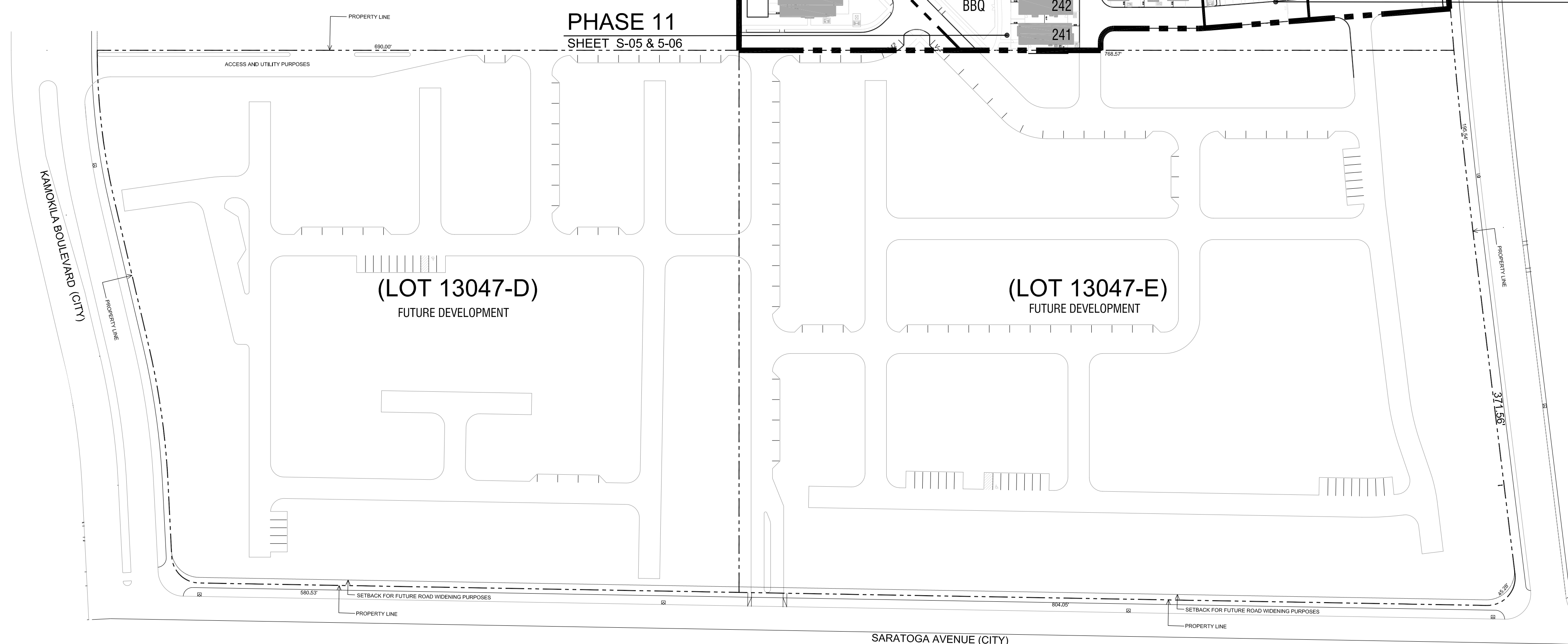

THESE DRAWINGS AND ACCOMPANYING SPECIFICATIONS ARE THE PROPERTY OF GENTRY KALAELOA, LLC. NO PART OF THIS PUBLICATION SHALL BE REPRODUCED OR TRANSMITTED IN ANY FORM OR BY ANY MEANS, ELECTRONIC OR MECHANICAL, INCLUDING PHOTOCOPYING, RECORDING, OR BY ANY INFORMATION STORAGE AND RETRIEVAL SYSTEM, WITHOUT THE WRITTEN PERMISSION OF GENTRY KALAELOA, LLC. ANY REPRODUCTION OR TRANSMISSION IN WHOLE OR IN PART, IS STRICTLY PROHIBITED EXCEPT BY WRITTEN PERMISSION OF GENTRY KALAELOA, LLC. ANY REPRODUCTION OR TRANSMISSION IN WHOLE OR IN PART, SHALL REMAIN WITH THE ARCHITECT WITHOUT PREJUDICE TO THE ARCHITECT'S OBLIGATIONS TO THE CLIENT. THIS DOCUMENT IS PREPARED BY GENTRY KALAELOA, LLC UNDER THE SUPERVISION AND CONTROL OF JACOB E. KASASIK, LICENSED PROFESSIONAL ARCHITECT, IN ACCORDANCE WITH HAWAII ADMINISTRATIVE RULES SECTION 18-15-10(C).
Jacob E. Kasasik EXP. DATE: 04/30/26

GENTRY KALAELOA, LLC
1010 KAPOLEI STREET, SUITE 100
KAPOLEI, HAWAII 96703
(808) 261-4000

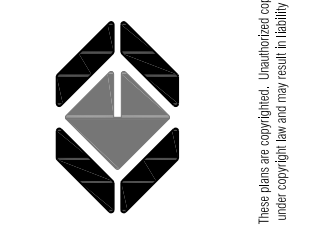

KA'ULU BY GENTRY
BUILDING CPR SET
GENTRY KALAELOA, LLC
HONOLULU, HAWAII

DRAWN BY: JM
CHECKED BY: KS JK
TRACK NO:
ISSUE DATE: 2024-03-01
REVISIONS:

CHAPTER:
SHEET TITLE:
KA'ULU BY GENTRY II
OVERALL SITE/KEY PLAN
LOCATION MAP
VICINITY MAP
SHEET NUMBER:

1
T-1 OVERALL SITE/ KEY PLAN
SCALE: 1"=80' (24"x36" SHEET)

T-1

KA'ULU BY GENTRY II

91-1101 FRANKLIN D. ROOSEVELT AVENUE,
KAPOLEI, HAWAII 96707

VA CENTER
(NOT PART OF KA'ULU BY GENTRY)

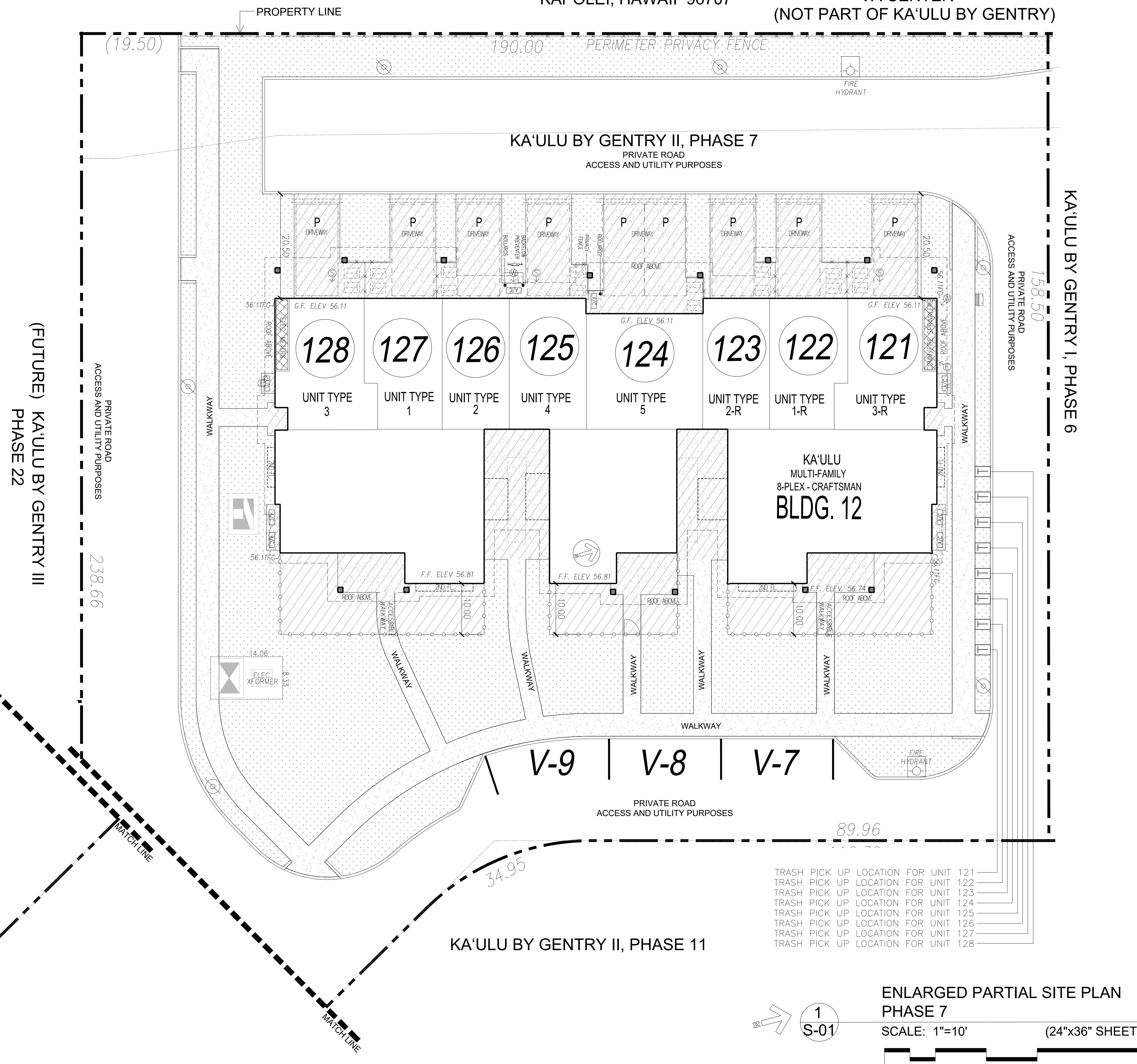

LEGEND:

- APPROX. LIMIT OF PRIVATE AREA (LIMITED COMMON ELEMENT)
- APPROXIMATE LIMIT OF ASSOCIATION LANDSCAPING (COMMON ELEMENT)
- APPROXIMATE LOCATION OF CONC. DRIVEWAY, WALKWAY, & PARKING (COMMON ELEMENT)
- MULTI-FAMILY BUILDING (LIMITED COMMON ELEMENT)
- ALL PARKING SPACES ARE STANDARD
- PICKET FENCE
- PRIVACY FENCE
- IRRIGATION SLEEVE
- APPROX. ELECTRICAL LINE LOCATION
- APPROX. SEWER LINE LOCATION
- APPROX. WATER LINE LOCATION
- APPROX. ELECT. METER LOCATION
- APPROX. LOCATION OF STREET LIGHT
- AIR CONDITIONING PAD
- TRASH/RECYCLE BIN LOCATION
- DRAIN / DRAIN LINE
- UTILITIES
- 1-HOUR FIRE RATED EXTERIOR WALL

NOTES:

- DIMENSIONS ARE TO EXTERIOR FRAMING UNLESS OTHERWISE NOTED.
- ALL CIVIL IS DIAGRAMMATIC AND STRICTLY FOR REFERENCE PURPOSES.
- WALKWAYS, DRIVEWAYS, PARKING, AND FENCED YARD SIZES, LOCATIONS, AND CONFIGURATIONS MAY VARY DUE TO JOBSITE CONDITIONS.
- ACTUAL LOCATIONS OF UTILITIES, COMMON ELEMENTS, LIMITED COMMON ELEMENTS, FENCES, AND OTHER FEATURES MAY VARY DUE TO ON-SITE CONDITIONS.
- PLAN #R IS REVERSE FLOOR PLAN
- ALL OFF-STREET PARKING SPACES, PARKING LOTS AND DRIVEWAYS SHALL BE PROVIDED AND MAINTAINED WITH AN ALL-WEATHER SURFACE.
- ALL LIMITED COMMON ELEMENT YARD AREAS TO BE LANDSCAPED ACCORDING TO CPR DECLARATION AND PROJECT RULES.
- ALL REQUIRED YARDS SHALL BE LANDSCAPED AND MAINTAINED IN HEALTHY CONDITION.
- THESE PLANS HAVE BEEN DESIGNED IN ACCORDANCE WITH CHAPTER 15-215, HAWAII ADMINISTRATIVE RULES, "KALAELOA COMMUNITY DEVELOPMENT DISTRICT RULES" (2012).

TRASH PICK UP LOCATION FOR UNIT 121
 TRASH PICK UP LOCATION FOR UNIT 122
 TRASH PICK UP LOCATION FOR UNIT 123
 TRASH PICK UP LOCATION FOR UNIT 124
 TRASH PICK UP LOCATION FOR UNIT 125
 TRASH PICK UP LOCATION FOR UNIT 126
 TRASH PICK UP LOCATION FOR UNIT 127
 TRASH PICK UP LOCATION FOR UNIT 128

1
S-01

ENLARGED PARTIAL SITE PLAN
 PHASE 7
 SCALE: 1"=10' (24"x36" SHEET)

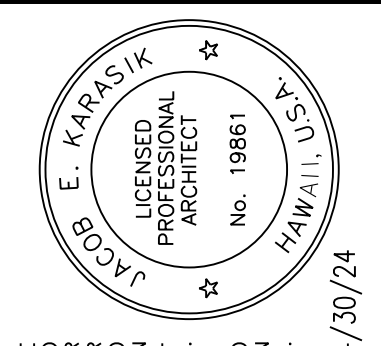
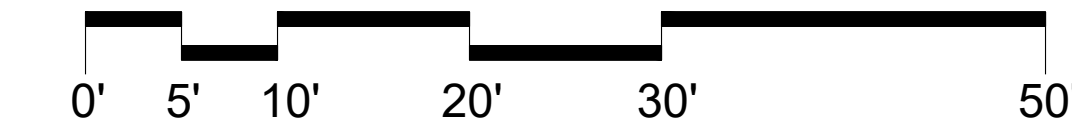

THESE DRAWINGS AND ACCOMPANYING SPECIFICATIONS ARE THE PROPERTY OF GENTRY KALAELOA, LLC. NO PART OF THIS PUBLICATION SHALL BE REPRODUCED OR TRANSMITTED IN ANY FORM OR BY ANY MEANS, ELECTRONIC OR MECHANICAL, INCLUDING PHOTOCOPYING, RECORDING, OR BY ANY INFORMATION STORAGE AND RETRIEVAL SYSTEM, WITHOUT THE WRITTEN PERMISSION OF GENTRY KALAELOA, LLC. ANY UNAUTHORIZED REPRODUCTION OR TRANSMISSION IS STRICTLY PROHIBITED EXCEPT BY WRITTEN PERMISSION OF GENTRY KALAELOA, LLC. THE ARCHITECT'S LIABILITY IS LIMITED TO THE PROFESSIONAL SERVICES PROVIDED AND SHALL NOT BE EXTENDED TO ANY OTHER MATTER. DATE: 04/30/24



KA'ULU BY GENTRY
 BUILDING CPR SET
 GENTRY KALAELOA, LLC
 HONOLULU, HAWAII

DRAWN BY:	JM
CHECKED BY:	KS JK
TRACK NO:	
ISSUE DATE:	2024-03-01
REVISIONS:	
CHAPTER:	
SHEET TITLE:	KA'ULU BY GENTRY II CPR SET
SHEET NUMBER:	ENLARGED PARTIAL SITE PLAN

S-01

KA'ULU BY GENTRY II

91-1101 FRANKLIN D. ROOSEVELT AVENUE,
KAPOLEI, HAWAII 96707

KA'ULU BY GENTRY I, PHASE 1

KA'ULU BY GENTRY I, PHASE 2

- TRASH PICK UP LOCATION FOR UNIT 198 OF PHASE 8*
- TRASH PICK UP LOCATION FOR UNIT 197 OF PHASE 8*
- TRASH PICK UP LOCATION FOR UNIT 196 OF PHASE 8*
- TRASH PICK UP LOCATION FOR UNIT 195 OF PHASE 8*
- TRASH PICK UP LOCATION FOR UNIT 194 OF PHASE 8*
- TRASH PICK UP LOCATION FOR UNIT 193 OF PHASE 8*
- TRASH PICK UP LOCATION FOR UNIT 192 OF PHASE 8*
- TRASH PICK UP LOCATION FOR UNIT 191 OF PHASE 8*

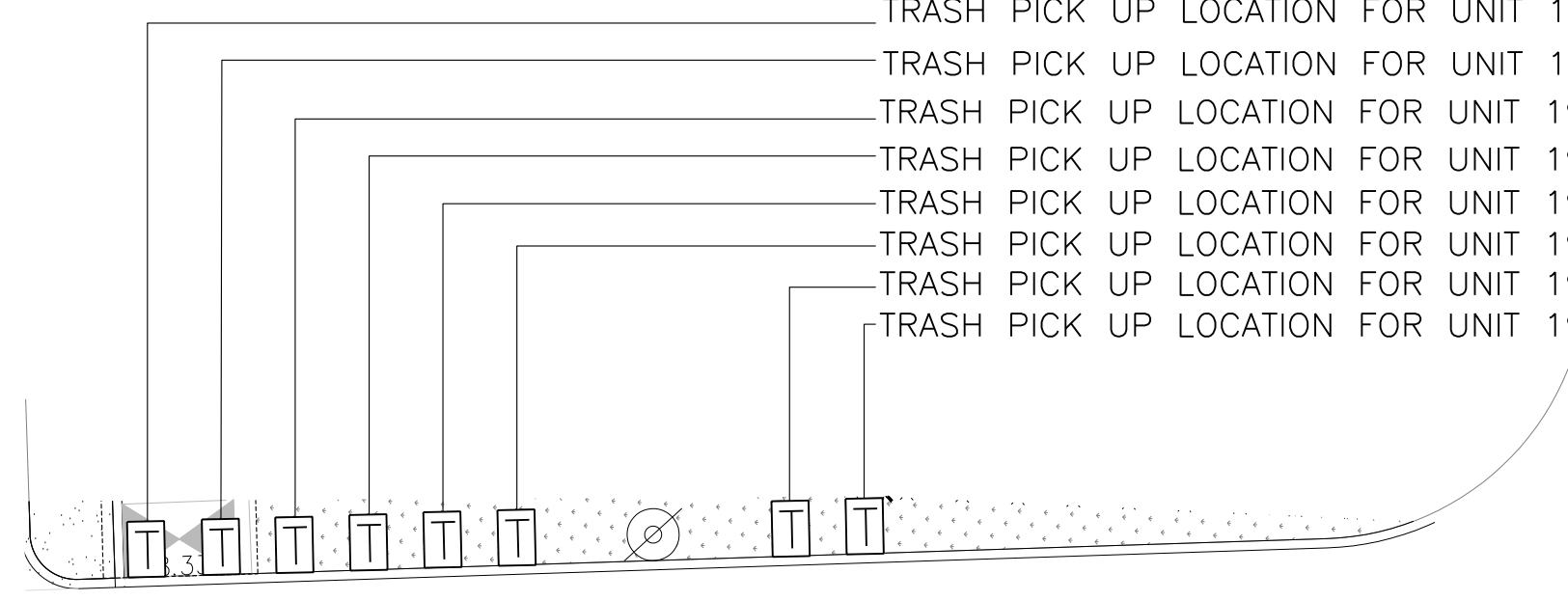

KA'ULU BY GENTRY II, PHASE 9

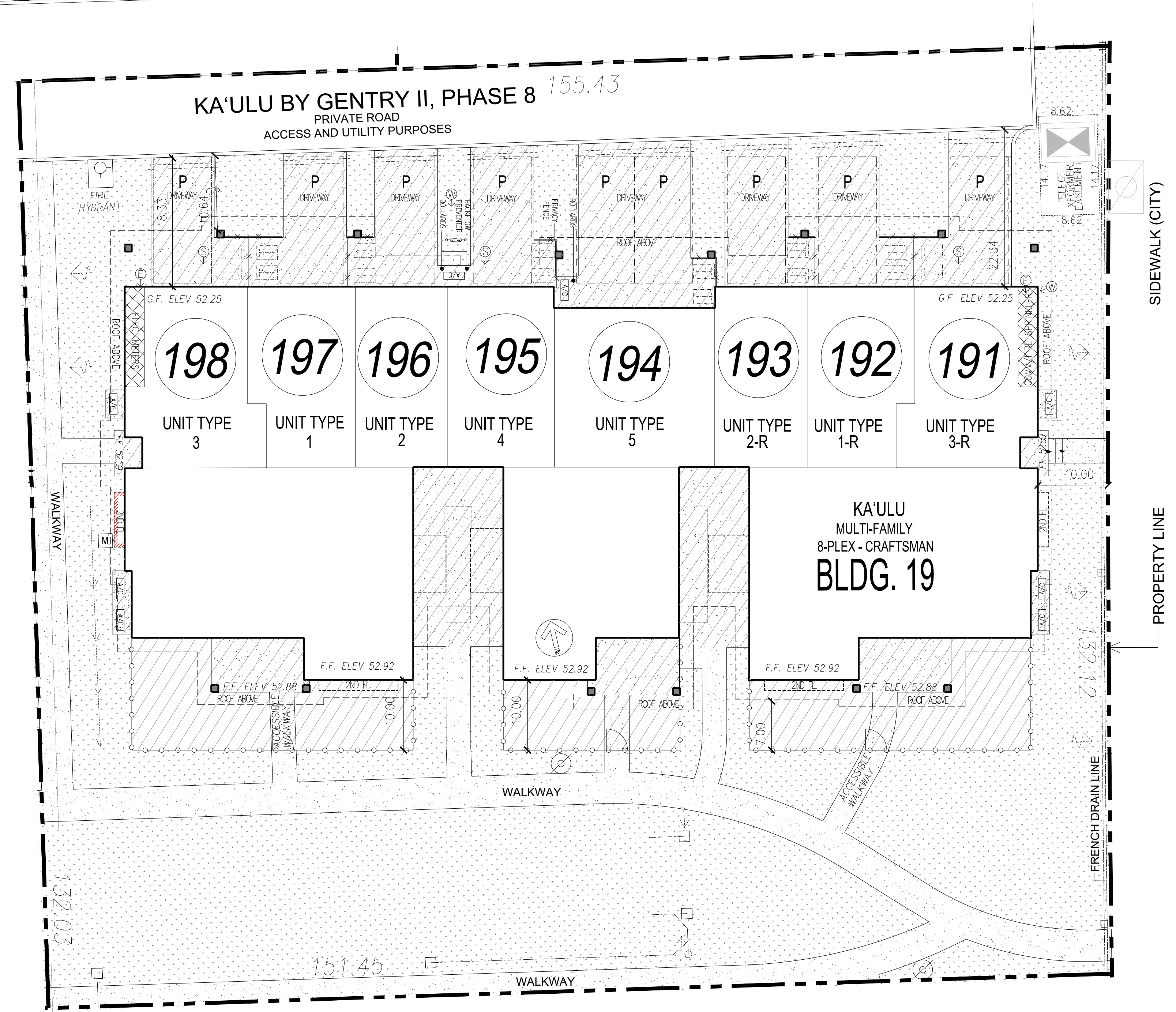

KA'ULU BY GENTRY II, PHASE 13

COPAHEE AVENUE

SIDEWALK (CITY)

PROPERTY LINE

LEGEND:

- APPROX. LIMIT OF PRIVATE AREA (LIMITED COMMON ELEMENT)
- APPROXIMATE LIMIT OF ASSOCIATION LANDSCAPING (COMMON ELEMENT)
- APPROXIMATE LOCATION OF CONC. DRIVEWAY, WALKWAY, & PARKING (COMMON ELEMENT)
- MULTI-FAMILY BUILDING (LIMITED COMMON ELEMENT)
- ALL PARKING SPACES ARE STANDARD
- PICKET FENCE
- PRIVACY FENCE
- IRRIGATION SLEEVE
- APPROX. ELECTRICAL LINE LOCATION
- APPROX. SEWER LINE LOCATION
- APPROX. WATER LINE LOCATION
- APPROX. ELECT. METER LOCATION
- APPROX. LOCATION OF STREET LIGHT
- AIR CONDITIONING PAD
- TRASH/RECYCLE BIN LOCATION
- DRAIN / DRAIN LINE
- UTILITIES
- 1-HOUR FIRE RATED EXTERIOR WALL

NOTES:

- DIMENSIONS ARE TO EXTERIOR FRAMING UNLESS OTHERWISE NOTED.
- ALL CIVIL IS DIAGRAMMATIC AND STRICTLY FOR REFERENCE PURPOSES.
- WALKWAYS, DRIVEWAYS, PARKING, AND FENCED YARD SIZES, LOCATIONS, AND CONFIGURATIONS MAY VARY DUE TO JOBSITE CONDITIONS.
- ACTUAL LOCATIONS OF UTILITIES, COMMON ELEMENTS, LIMITED COMMON ELEMENTS, FENCES, AND OTHER FEATURES MAY VARY DUE TO ON-SITE CONDITIONS.
- PLAN #-R IS REVERSE FLOOR PLAN
- ALL OFF-STREET PARKING SPACES, PARKING LOTS AND DRIVEWAYS SHALL BE PROVIDED AND MAINTAINED WITH AN ALL-WEATHER SURFACE.
- ALL LIMITED COMMON ELEMENT YARD AREAS TO BE LANDSCAPED ACCORDING TO CPR DECLARATION AND PROJECT RULES.
- ALL REQUIRED YARDS SHALL BE LANDSCAPED AND MAINTAINED IN HEALTHY CONDITION.
- THESE PLANS HAVE BEEN DESIGNED IN ACCORDANCE WITH CHAPTER 15-215, HAWAII ADMINISTRATIVE RULES, "KALAELOA COMMUNITY DEVELOPMENT DISTRICT RULES" (2012).
- AS SET FORTH IN THE CONDOMINIUM DECLARATION FOR KA'ULU BY GENTRY II, SUBJECT TO CERTAIN RESTRICTIONS, THE OWNERS AND RESIDENTS OF UNITS 191-198 OF THE KA'ULU BY GENTRY II, PHASE 8 CONDOMINIUM PROJECT SHALL EACH HAVE THE RIGHT TO PLACE THEIR RESPECTIVE TRASH CONTAINERS ON THE PORTION OF THE PROJECT THAT IS DESIGNATED ON KA'ULU BY GENTRY I, PHASE 1 FOR THE PLACEMENT OF SUCH CONTAINERS, AS WELL AS ACCESS TO SUCH LOCATION.

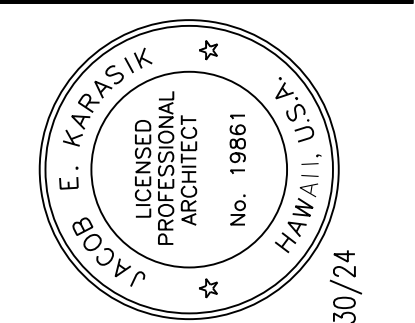

THESE DRAWINGS AND ACCOMPANYING SPECIFICATIONS ARE THE PROPERTY OF GENTRY KALAELOA, LLC. NO PART OF THESE DRAWINGS OR SPECIFICATIONS SHALL BE REPRODUCED OR TRANSMITTED IN ANY FORM OR BY ANY MEANS, ELECTRONIC OR MECHANICAL, INCLUDING PHOTOCOPYING, RECORDING, OR BY ANY INFORMATION STORAGE AND RETRIEVAL SYSTEM, WITHOUT THE WRITTEN PERMISSION OF GENTRY KALAELOA, LLC. DATE: 04/30/24



KA'ULU BY GENTRY
BUILDING CPR SET
GENTRY KALAELOA, LLC
HONOLULU, HAWAII

DRAWN BY: JM
CHECKED BY: KS JS
TRACK NO:
ISSUE DATE: 2024-03-01
REVISIONS:

CHAPTER:
SHEET TITLE:
KA'ULU BY GENTRY II
CPR SET
ENLARGED PARTIAL SITE PLAN
SHEET NUMBER:

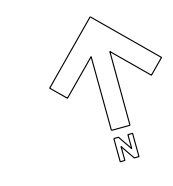

1
S-02

ENLARGED PARTIAL SITE PLAN
PHASE 8

SCALE: 1"=10' (24"x36" SHEET)



S-02

KA'ULU BY GENTRY II

91-1101 FRANKLIN D. ROOSEVELT AVENUE,
KAPOLEI, HAWAII 96707

KA'ULU BY GENTRY I, PHASE 1

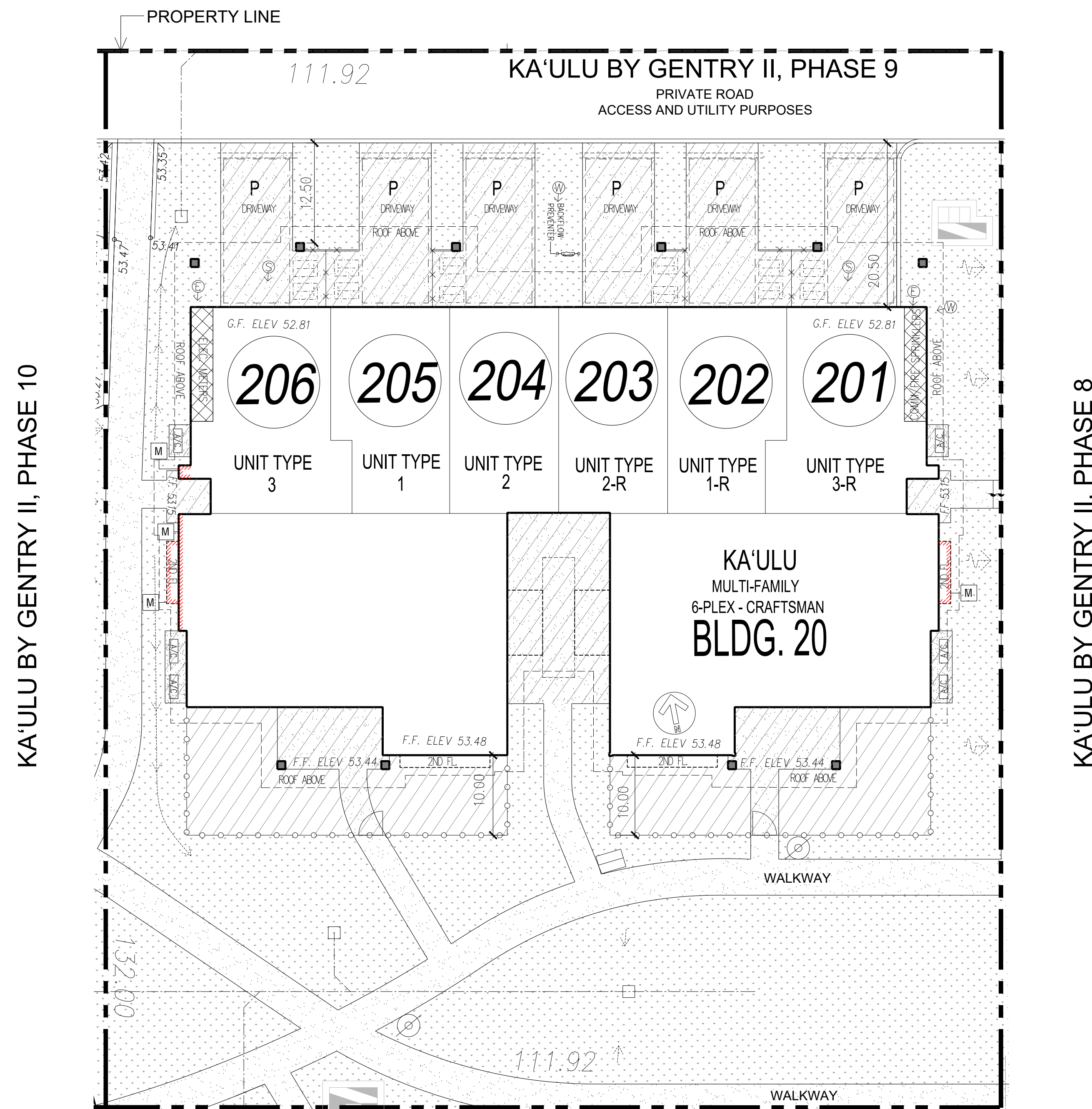

KA'ULU BY GENTRY II, PHASE 10

KA'ULU BY GENTRY II, PHASE 8

KA'ULU BY GENTRY II, PHASE 12

ENLARGED PARTIAL SITE PLAN PHASE 9

SCALE: 1"=10' (24"x36" SHEET)



LEGEND:

- APPROX. LIMIT OF PRIVATE AREA (LIMITED COMMON ELEMENT)
- APPROXIMATE LIMIT OF ASSOCIATION LANDSCAPING (COMMON ELEMENT)
- APPROXIMATE LOCATION OF CONC. DRIVEWAY, WALKWAY, & PARKING (COMMON ELEMENT)
- MULTI-FAMILY BUILDING (LIMITED COMMON ELEMENT)
- ALL PARKING SPACES ARE STANDARD
- PICKET FENCE
- PRIVACY FENCE
- IRRIGATION SLEEVE
- APPROX. ELECTRICAL LINE LOCATION
- APPROX. SEWER LINE LOCATION
- APPROX. WATER LINE LOCATION
- APPROX. ELECT. METER LOCATION
- APPROX. LOCATION OF STREET LIGHT
- AIR CONDITIONING PAD
- TRASH/RECYCLE BIN LOCATION
- DRAIN / DRAIN LINE
- UTILITIES
- 1-HOUR FIRE RATED EXTERIOR WALL

NOTES:

- DIMENSIONS ARE TO EXTERIOR FRAMING UNLESS OTHERWISE NOTED.
- ALL CIVIL IS DIAGRAMMATIC AND STRICTLY FOR REFERENCE PURPOSES.
- WALKWAYS, DRIVEWAYS, PARKING AND FENCED YARD SIZES, LOCATIONS, AND CONFIGURATIONS MAY VARY DUE TO JOBSITE CONDITIONS.
- ACTUAL LOCATIONS OF UTILITIES, COMMON ELEMENTS, LIMITED COMMON ELEMENTS, FENCES, AND OTHER FEATURES MAY VARY DUE TO ON-SITE CONDITIONS.
- PLAN #R IS REVERSE FLOOR PLAN
- ALL OFF-STREET PARKING SPACES, PARKING LOTS AND DRIVEWAYS SHALL BE PROVIDED AND MAINTAINED WITH AN ALL-WEATHER SURFACE.
- ALL LIMITED COMMON ELEMENT YARD AREAS TO BE LANDSCAPED ACCORDING TO CPR DECLARATION AND PROJECT RULES.
- ALL REQUIRED YARDS SHALL BE LANDSCAPED AND MAINTAINED IN HEALTHY CONDITION.
- THESE PLANS HAVE BEEN DESIGNED IN ACCORDANCE WITH CHAPTER 15-215, HAWAII ADMINISTRATIVE RULES, "KALAELOA COMMUNITY DEVELOPMENT DISTRICT RULES" (2012).



THESE DRAWINGS AND ACCOMPANYING SPECIFICATIONS ARE THE PROPERTY OF GENTRY KALAELOA, LLC. NO PART OF THIS PUBLICATION SHALL BE REPRODUCED OR TRANSMITTED IN ANY FORM OR BY ANY MEANS, ELECTRONIC OR MECHANICAL, INCLUDING PHOTOCOPYING, RECORDING, OR BY ANY INFORMATION STORAGE AND RETRIEVAL SYSTEM, WITHOUT THE WRITTEN PERMISSION OF GENTRY KALAELOA, LLC. THESE DRAWINGS AND ACCOMPANYING SPECIFICATIONS ARE THE PROPERTY OF GENTRY KALAELOA, LLC. NO PART OF THIS PUBLICATION SHALL BE REPRODUCED OR TRANSMITTED IN ANY FORM OR BY ANY MEANS, ELECTRONIC OR MECHANICAL, INCLUDING PHOTOCOPYING, RECORDING, OR BY ANY INFORMATION STORAGE AND RETRIEVAL SYSTEM, WITHOUT THE WRITTEN PERMISSION OF GENTRY KALAELOA, LLC.

DATE: 04/30/24



KA'ULU BY GENTRY
BUILDING CPR SET
GENTRY KALAELOA, LLC
HONOLULU, HAWAII

DRAWN BY: JM
CHECKED BY: KS JK
TRACK NO:
ISSUE DATE: 2024-03-01
REVISIONS:
CHAPTER:
SHEET TITLE:
KA'ULU BY GENTRY II
CPR SET
ENLARGED PARTIAL SITE PLAN
SHEET NUMBER:

S-03

KA'ULU BY GENTRY II

91-1101 FRANKLIN D. ROOSEVELT AVENUE,
KAPOLEI, HAWAII 96707

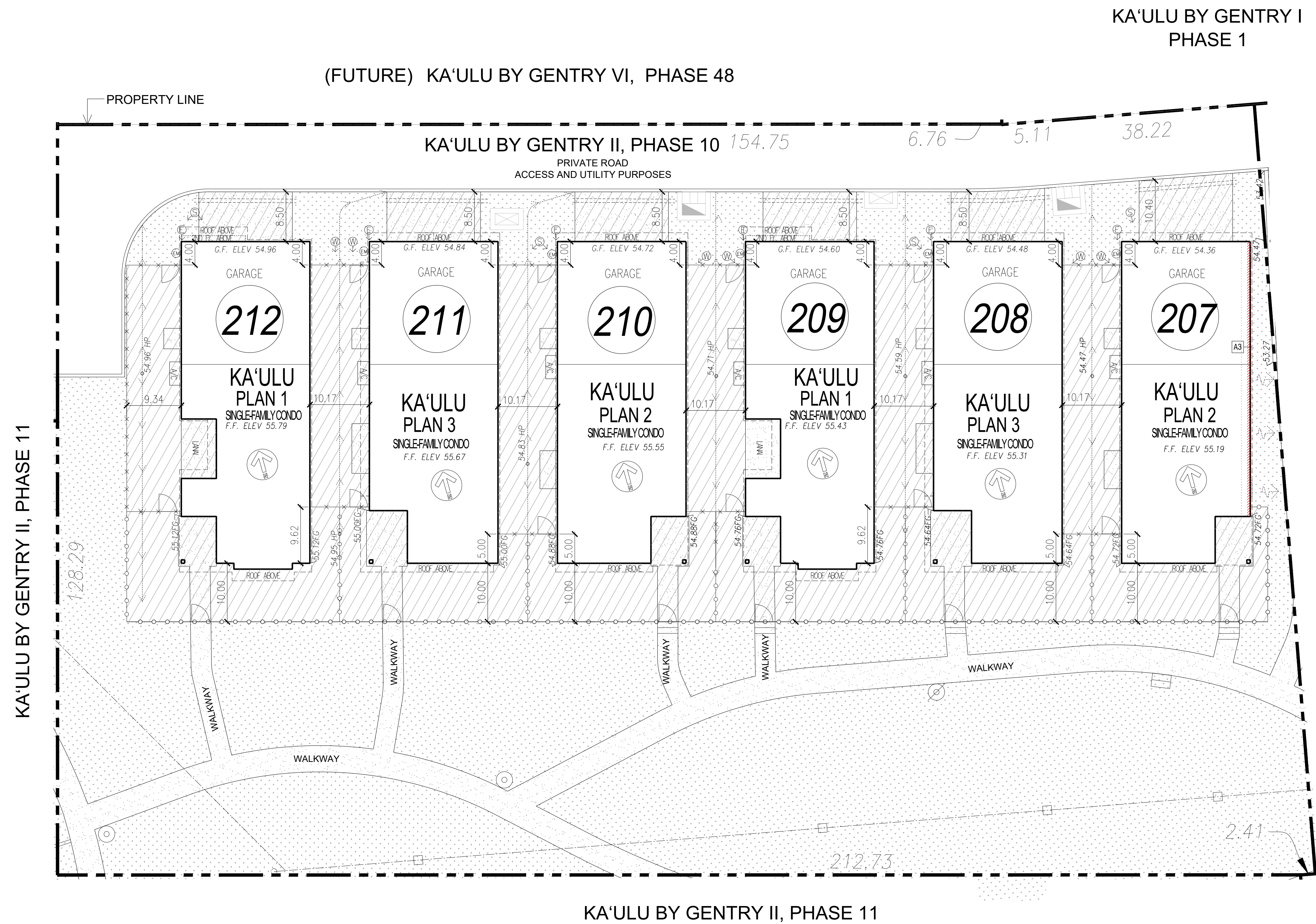

LEGEND:

- APPROX. LIMIT OF PRIVATE AREA (LIMITED COMMON ELEMENT)
- APPROXIMATE LIMIT OF ASSOCIATION LANDSCAPING (COMMON ELEMENT)
- APPROXIMATE LOCATION OF CONC. DRIVEWAY, WALKWAY, & PARKING (COMMON ELEMENT)
- MULTI-FAMILY BUILDING (LIMITED COMMON ELEMENT)
- ALL PARKING SPACES ARE STANDARD
- PICKET FENCE
- PRIVACY FENCE
- IRRIGATION SLEEVE
- APPROX. ELECTRICAL LINE LOCATION
- APPROX. SEWER LINE LOCATION
- APPROX. WATER LINE LOCATION
- APPROX. ELECT. METER LOCATION
- APPROX. LOCATION OF STREET LIGHT
- AIR CONDITIONING PAD
- TRASH/RECYCLE BIN LOCATION
- DRAIN / DRAIN LINE
- UTILITIES
- 1-HOUR FIRE RATED EXTERIOR WALL

NOTES:

- DIMENSIONS ARE TO EXTERIOR FRAMING UNLESS OTHERWISE NOTED.
- ALL CIVIL IS DIAGMMATIC AND STRICTLY FOR REFERENCE PURPOSES.
- WALKWAYS, DRIVEWAYS, PARKING, AND FENCED YARD SIZES, LOCATIONS, AND CONFIGURATIONS MAY VARY DUE TO JOBSITE CONDITIONS.
- ACTUAL LOCATIONS OF UTILITIES, COMMON ELEMENTS, LIMITED COMMON ELEMENTS, FENCES, AND OTHER FEATURES MAY VARY DUE TO ON-SITE CONDITIONS.
- PLAN #-R IS REVERSE FLOOR PLAN
- ALL OFF-STREET PARKING SPACES, PARKING LOTS AND DRIVEWAYS SHALL BE PROVIDED AND MAINTAINED WITH AN ALL-WEATHER SURFACE.
- ALL LIMITED COMMON ELEMENT YARD AREAS TO BE LANDSCAPED ACCORDING TO CPR DECLARATION AND PROJECT RULES.
- ALL REQUIRED YARDS SHALL BE LANDSCAPED AND MAINTAINED IN HEALTHY CONDITION.
- THESE PLANS HAVE BEEN DESIGNED IN ACCORDANCE WITH CHAPTER 15-215, HAWAII ADMINISTRATIVE RULES, "KALAELOA COMMUNITY DEVELOPMENT DISTRICT RULES" (2012).



THESE DRAWINGS AND ACCOMPANYING SPECIFICATIONS ARE THE PROPERTY OF GENTRY KALAELOA, LLC. NO PART OF THESE DRAWINGS OR SPECIFICATIONS SHALL BE REPRODUCED OR TRANSMITTED IN ANY FORM OR BY ANY MEANS, ELECTRONIC OR MECHANICAL, INCLUDING PHOTOCOPYING, RECORDING, OR BY ANY INFORMATION STORAGE AND RETRIEVAL SYSTEM, WITHOUT THE WRITTEN PERMISSION OF GENTRY KALAELOA, LLC. ANY UNAUTHORIZED REPRODUCTION OR TRANSMISSION IS STRICTLY PROHIBITED EXCEPT BY WRITTEN PERMISSION OF GENTRY KALAELOA, LLC. THESE DRAWINGS AND ACCOMPANYING SPECIFICATIONS SHALL BE USED ONLY FOR THE PROJECT AND SITE SPECIFICALLY IDENTIFIED HEREIN. ANY OTHER USE IS STRICTLY PROHIBITED. DATE: 04/30/24

GENTRY KALAELOA, LLC
1555 KAPOLEI DRIVE, SUITE 100
KAPOLEI, HAWAII 96761
(808) 261-0000

KA'ULU BY GENTRY
BUILDING CPR SET
GENTRY KALAELOA, LLC
HONOLULU, HAWAII

DRAWN BY: JM
CHECKED BY: KS JK
TRACK NO:
ISSUE DATE: 2024-03-01
REVISIONS:

CHAPTER:
SHEET TITLE:
KA'ULU BY GENTRY II
CPR SET
ENLARGED PARTIAL SITE PLAN
SHEET NUMBER:

S-04

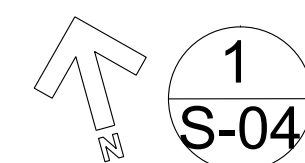

ENLARGED PARTIAL SITE PLAN
PHASE 10
SCALE: 1"=10' (24"x36" SHEET)

KA'ULU BY GENTRY II

91-1101 FRANKLIN D. ROOSEVELT AVENUE,
KAPOLEI, HAWAII 96707

KA'ULU BY GENTRY II, PHASE 10

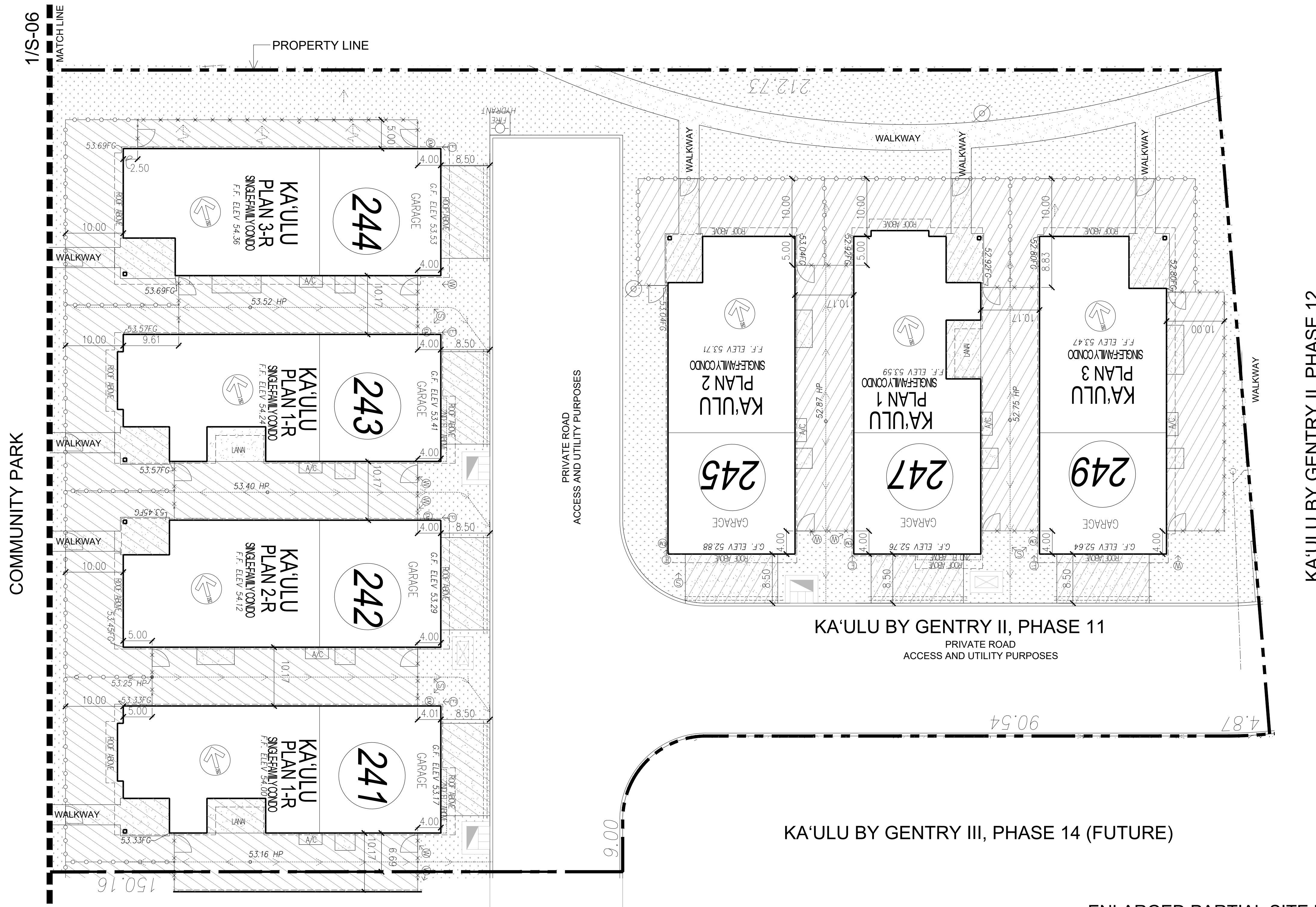

LEGEND:

- APPROX. LIMIT OF PRIVATE AREA (LIMITED COMMON ELEMENT)
- APPROXIMATE LIMIT OF ASSOCIATION LANDSCAPING (COMMON ELEMENT)
- APPROXIMATE LOCATION OF CONC. DRIVEWAY, WALKWAY, & PARKING (COMMON ELEMENT)
- MULTI-FAMILY BUILDING (LIMITED COMMON ELEMENT)
- ALL PARKING SPACES ARE STANDARD
- PICKET FENCE
- PRIVACY FENCE
- IRRIGATION SLEEVE
- APPROX. ELECTRICAL LINE LOCATION
- APPROX. SEWER LINE LOCATION
- APPROX. WATER LINE LOCATION
- APPROX. ELECT. METER LOCATION
- APPROX. LOCATION OF STREET LIGHT
- AIR CONDITIONING PAD
- TRASH/RECYCLE BIN LOCATION
- DRAIN / DRAIN LINE
- UTILITIES
- 1-HOUR FIRE RATED EXTERIOR WALL

NOTES:

- DIMENSIONS ARE TO EXTERIOR FRAMING UNLESS OTHERWISE NOTED.
- ALL CIVIL IS DIAGRAMMATIC AND STRICTLY FOR REFERENCE PURPOSES.
- WALKWAYS, DRIVEWAYS, PARKING, AND FENCED YARD SIZES, LOCATIONS, AND CONFIGURATIONS MAY VARY DUE TO JOBSITE CONDITIONS.
- ACTUAL LOCATIONS OF UTILITIES, COMMON ELEMENTS, LIMITED COMMON ELEMENTS, FENCES, AND OTHER FEATURES MAY VARY DUE TO ON-SITE CONDITIONS.
- PLAN #-R IS REVERSE FLOOR PLAN
- ALL OFF-STREET PARKING SPACES, PARKING LOTS AND DRIVEWAYS SHALL BE PROVIDED AND MAINTAINED WITH AN ALL-WEATHER SURFACE.
- ALL LIMITED COMMON ELEMENT YARD AREAS TO BE LANDSCAPED ACCORDING TO CPR DECLARATION AND PROJECT RULES.
- ALL REQUIRED YARDS SHALL BE LANDSCAPED AND MAINTAINED IN HEALTHY CONDITION.
- THESE PLANS HAVE BEEN DESIGNED IN ACCORDANCE WITH CHAPTER 15-215, HAWAII ADMINISTRATIVE RULES, "KALAELOA COMMUNITY DEVELOPMENT DISTRICT RULES" (2012).

ENLARGED PARTIAL SITE PLAN PHASE 11

SCALE: 1"=10' (24"x36" SHEET)



THESE DRAWINGS AND ACCOMPANYING SPECIFICATIONS ARE THE PROPERTY OF GENTRY KALAELOA, LLC. NO PART OF THIS PUBLICATION SHALL BE REPRODUCED OR TRANSMITTED IN ANY FORM OR BY ANY MEANS, ELECTRONIC OR MECHANICAL, INCLUDING PHOTOCOPYING, RECORDING, OR BY ANY INFORMATION STORAGE AND RETRIEVAL SYSTEM, WITHOUT THE WRITTEN PERMISSION OF GENTRY KALAELOA, LLC. THESE DRAWINGS AND SPECIFICATIONS ARE TO BE USED ONLY FOR THE PROJECT AND SITE SPECIFICALLY IDENTIFIED HEREIN. ANY REUSE OR MODIFICATION OF THESE DRAWINGS WITHOUT THE WRITTEN PERMISSION OF GENTRY KALAELOA, LLC IS STRICTLY PROHIBITED EXCEPT BY WRITTEN PERMISSION OF GENTRY KALAELOA, LLC. THE ARCHITECT ASSUMES NO LIABILITY FOR CONSTRUCTION OF THE PROJECT UNLESS THE ARCHITECT IS SPECIFICALLY NOTED AS SUCH. DATE: 04/30/24

GENTRY KALAELOA, LLC
1111 KAPOLEI DRIVE, SUITE 100
KAPOLEI, HAWAII 96761
(808) 261-1111

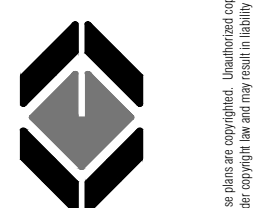

KA'ULU BY GENTRY
BUILDING CPR SET
GENTRY KALAELOA, LLC
HONOLULU, HAWAII

DRAWN BY: JM
CHECKED BY: KS JK
TRACK NO:
ISSUE DATE: 2024-03-01
REVISIONS:

CHAPTER:
SHEET TITLE:
KA'ULU BY GENTRY II
CPR SET
ENLARGED PARTIAL SITE PLAN
SHEET NUMBER:

S-05

(FUTURE) KA'ULU BY GENTRY VI, PHASE 49

KA'ULU BY GENTRY II

91-1101 FRANKLIN D. ROOSEVELT AVENUE,
KAPOLEI, HAWAII 96707

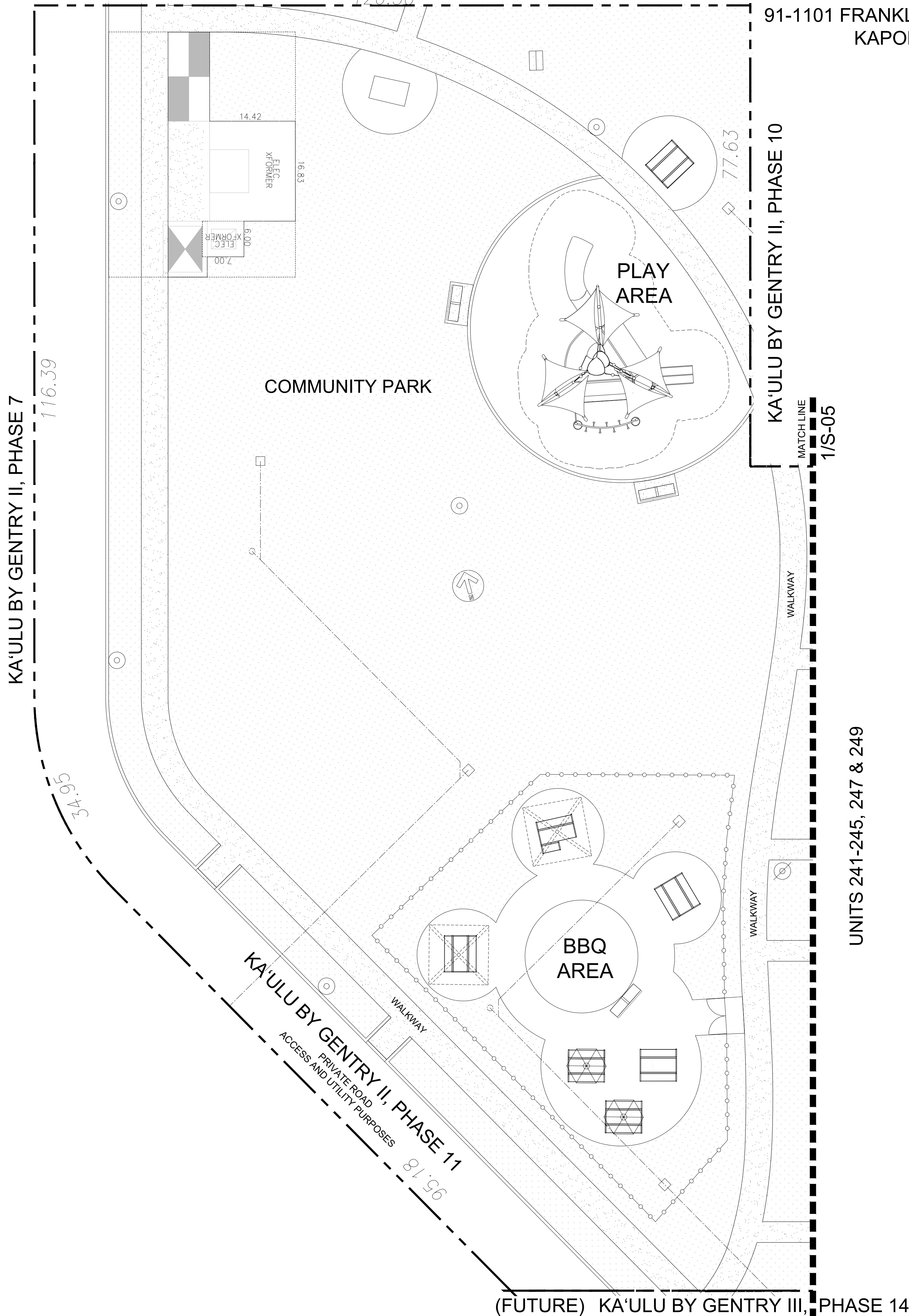

UNITS 241-245, 247 & 249

1
S-06

ENLARGED PARTIAL SITE PLAN PHASE 11, COMMUNITY PARK

SCALE: 1"=10' (24"x36" SHEET)



LEGEND:

- APPROX. LIMIT OF PRIVATE AREA (LIMITED COMMON ELEMENT)
- APPROXIMATE LIMIT OF ASSOCIATION LANDSCAPING (COMMON ELEMENT)
- APPROXIMATE LOCATION OF CONC. DRIVEWAY, WALKWAY, & PARKING (COMMON ELEMENT)
- MULTI-FAMILY BUILDING (LIMITED COMMON ELEMENT)
- ALL PARKING SPACES ARE STANDARD
- PICKET FENCE
- PRIVACY FENCE
- IRRIGATION SLEEVE
- APPROX. ELECTRICAL LINE LOCATION
- APPROX. SEWER LINE LOCATION
- APPROX. WATER LINE LOCATION
- APPROX. ELECT. METER LOCATION
- APPROX. LOCATION OF STREET LIGHT
- AIR CONDITIONING PAD
- TRASH/RECYCLE BIN LOCATION
- DRAIN / DRAIN LINE
- UTILITIES
- 1-HOUR FIRE RATED EXTERIOR WALL

NOTES:

- DIMENSIONS ARE TO EXTERIOR FRAMING UNLESS OTHERWISE NOTED.
- ALL CIVIL IS DIAGRAMMATIC AND STRICTLY FOR REFERENCE PURPOSES.
- WALKWAYS, DRIVEWAYS, PARKING, AND FENCED YARD SIZES, LOCATIONS, AND CONFIGURATIONS MAY VARY DUE TO JOBSITE CONDITIONS.
- ACTUAL LOCATIONS OF UTILITIES, COMMON ELEMENTS, LIMITED COMMON ELEMENTS, FENCES, AND OTHER FEATURES MAY VARY DUE TO ON-SITE CONDITIONS.
- PLAN #R IS REVERSE FLOOR PLAN
- ALL OFF-STREET PARKING SPACES, PARKING LOTS AND DRIVEWAYS SHALL BE PROVIDED AND MAINTAINED WITH AN ALL-WEATHER SURFACE.
- ALL LIMITED COMMON ELEMENT YARD AREAS TO BE LANDSCAPED ACCORDING TO CPR DECLARATION AND PROJECT RULES.
- ALL REQUIRED YARDS SHALL BE LANDSCAPED AND MAINTAINED IN HEALTHY CONDITION.
- THESE PLANS HAVE BEEN DESIGNED IN ACCORDANCE WITH CHAPTER 15-215, HAWAII ADMINISTRATIVE RULES, "KALAELOA COMMUNITY DEVELOPMENT DISTRICT RULES" (2012).

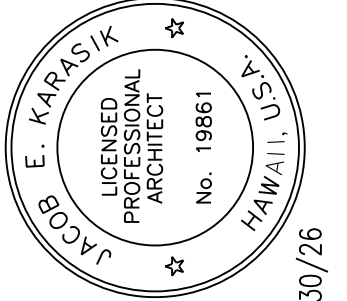

THESE DRAWINGS AND ACCOMPANYING SPECIFICATIONS ARE THE PROPERTY OF GENTRY KALAELOA, LLC. NO PART OF THIS PUBLICATION SHALL BE REPRODUCED OR TRANSMITTED IN ANY FORM OR BY ANY MEANS, ELECTRONIC OR MECHANICAL, INCLUDING PHOTOCOPYING, RECORDING, OR BY ANY INFORMATION STORAGE AND RETRIEVAL SYSTEM, WITHOUT THE WRITTEN PERMISSION OF GENTRY KALAELOA, LLC. THIS DOCUMENT IS PREPARED BY AN ARCHITECT UNDER THE SUPERVISION AND CONTROL OF AN ARCHITECT. ANY VIOLATION OF THESE CONDITIONS SHALL BE STRICTLY PROHIBITED EXCEPT BY WRITTEN PERMISSION OF GENTRY KALAELOA, LLC. THESE DRAWINGS SHALL REMAIN THE PROPERTY OF GENTRY KALAELOA, LLC. DATE: 04/30/26

GENTRY KALAELOA, LLC
1111 KAPOLEI DRIVE, SUITE 100
KAPOLEI, HAWAII 96763
(808) 261-1000

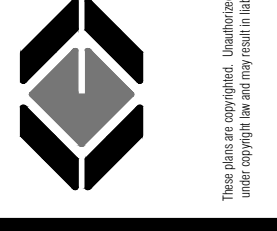

KA'ULU BY GENTRY
BUILDING CPR SET
GENTRY KALAELOA, LLC
HONOLULU, HAWAII

DRAWN BY: JM
CHECKED BY: KS JK
TRACK NO:
ISSUE DATE: 2024-03-01
REVISIONS:

CHAPTER:
SHEET TITLE:
KA'ULU BY GENTRY II
CPR SET
ENLARGED PARTIAL SITE PLAN
SHEET NUMBER:

S-06

KA'ULU BY GENTRY II

91-1101 FRANKLIN D. ROOSEVELT AVENUE,
KAPOLEI, HAWAII 96707

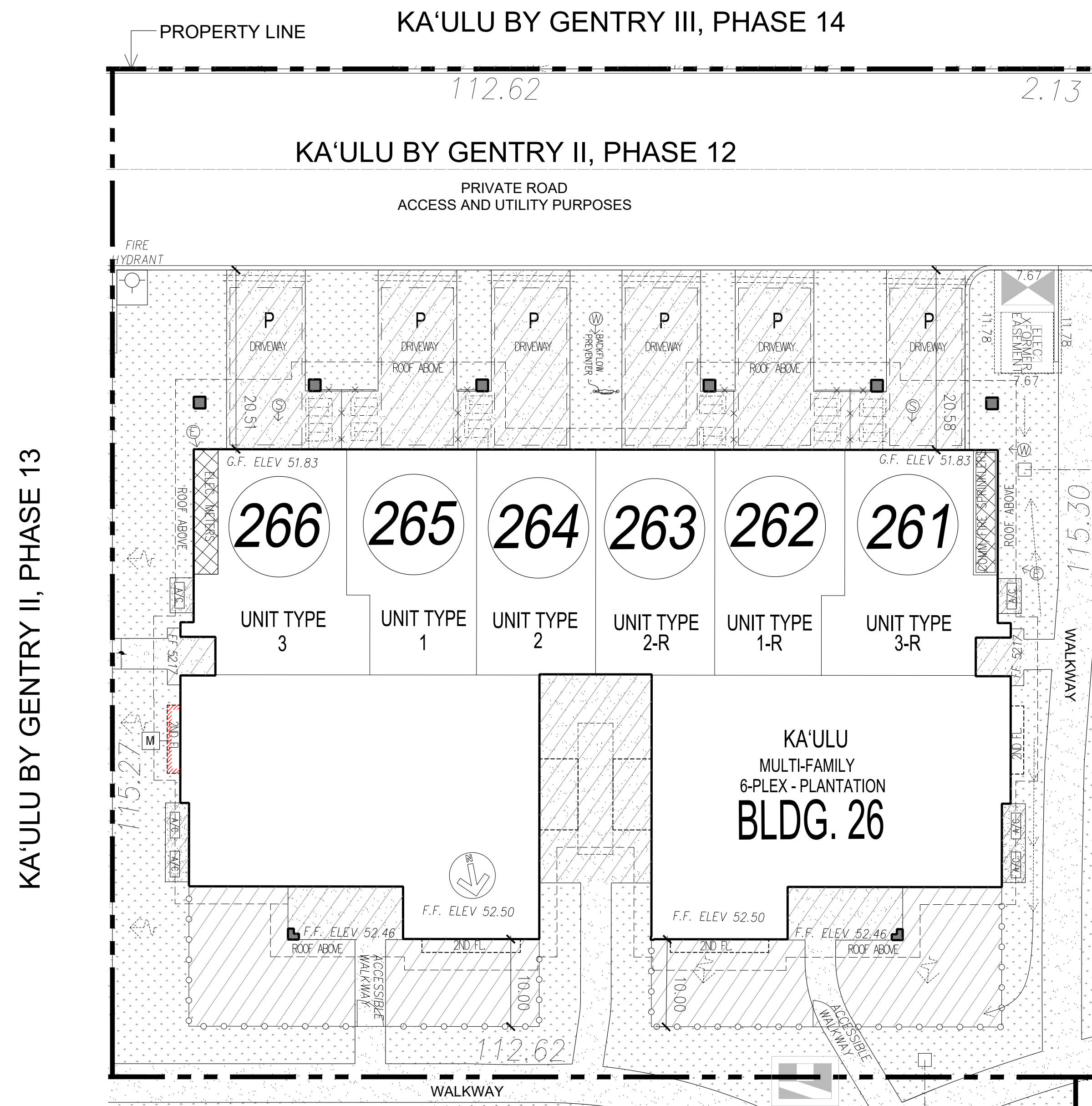

KA'ULU BY GENTRY II, PHASE 13

KA'ULU BY GENTRY II, PHASE 11

KA'ULU BY GENTRY II, PHASE 9

LEGEND:

- APPROX. LIMIT OF PRIVATE AREA (LIMITED COMMON ELEMENT)
- APPROXIMATE LIMIT OF ASSOCIATION LANDSCAPING (COMMON ELEMENT)
- APPROXIMATE LOCATION OF CONC. DRIVEWAY, WALKWAY, & PARKING (COMMON ELEMENT)
- MULTI-FAMILY BUILDING (LIMITED COMMON ELEMENT)
- ALL PARKING SPACES ARE STANDARD
- PICKET FENCE
- PRIVACY FENCE
- IRRIGATION SLEEVE
- APPROX. ELECTRICAL LINE LOCATION
- APPROX. SEWER LINE LOCATION
- APPROX. WATER LINE LOCATION
- APPROX. ELECT. METER LOCATION
- APPROX. LOCATION OF STREET LIGHT
- AIR CONDITIONING PAD
- TRASH/RECYCLE BIN LOCATION
- DRAIN / DRAIN LINE
- UTILITIES
- 1-HOUR FIRE RATED EXTERIOR WALL

NOTES:

- DIMENSIONS ARE TO EXTERIOR FRAMING UNLESS OTHERWISE NOTED.
- ALL CIVIL IS DIAGRAMMATIC AND STRICTLY FOR REFERENCE PURPOSES.
- WALKWAYS, DRIVEWAYS, PARKING, AND FENCED YARD SIZES, LOCATIONS, AND CONFIGURATIONS MAY VARY DUE TO JOBSITE CONDITIONS.
- ACTUAL LOCATIONS OF UTILITIES, COMMON ELEMENTS, LIMITED COMMON ELEMENTS, FENCES, AND OTHER FEATURES MAY VARY DUE TO ON-SITE CONDITIONS.
- PLAN #-R IS REVERSE FLOOR PLAN
- ALL OFF-STREET PARKING SPACES, PARKING LOTS AND DRIVEWAYS SHALL BE PROVIDED AND MAINTAINED WITH AN ALL-WEATHER SURFACE.
- ALL LIMITED COMMON ELEMENT YARD AREAS TO BE LANDSCAPED ACCORDING TO CPR DECLARATION AND PROJECT RULES.
- ALL REQUIRED YARDS SHALL BE LANDSCAPED AND MAINTAINED IN HEALTHY CONDITION.
- THESE PLANS HAVE BEEN DESIGNED IN ACCORDANCE WITH CHAPTER 15-215, HAWAII ADMINISTRATIVE RULES, "KALAELOA COMMUNITY DEVELOPMENT DISTRICT RULES" (2012).

ENLARGED PARTIAL SITE PLAN
PHASE 12

SCALE: 1"=10' (24"x36" SHEET)



1
S-07

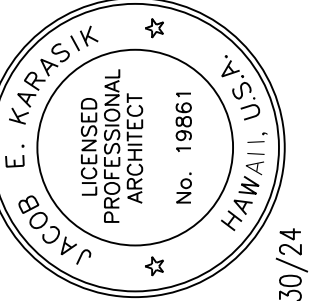

THESE DRAWINGS AND ACCOMPANYING SPECIFICATIONS ARE THE PROPERTY OF GENTRY KALAELOA, LLC. NO PART OF THIS PUBLICATION SHALL BE REPRODUCED OR TRANSMITTED IN ANY FORM OR BY ANY MEANS, ELECTRONIC OR MECHANICAL, INCLUDING PHOTOCOPYING, RECORDING, OR BY ANY INFORMATION STORAGE AND RETRIEVAL SYSTEM, WITHOUT THE WRITTEN PERMISSION OF GENTRY KALAELOA, LLC. THESE DRAWINGS AND ACCOMPANYING SPECIFICATIONS ARE TO BE USED ONLY FOR THE PROJECT AND SITE SPECIFICALLY IDENTIFIED HEREIN. ANY REUSE OR MODIFICATION OF THESE DRAWINGS WITHOUT THE WRITTEN PERMISSION OF GENTRY KALAELOA, LLC IS STRICTLY PROHIBITED EXCEPT BY WRITTEN PERMISSION OF GENTRY KALAELOA, LLC. CONDITIONS SHALL REMAIN WITH THE ARCHITECT WITHOUT PREJUDICE.

DESIGNED BY: JACOB E. KASASIK
CHECKED BY: JACOB E. KASASIK
DATE: 04/30/24



KA'ULU BY GENTRY
BUILDING CPR SET
GENTRY KALAELOA, LLC
HONOLULU, HAWAII

DRAWN BY: JM
CHECKED BY: KS JK
TRACK NO:
ISSUE DATE: 2024-03-01
REVISIONS:
CHAPTER:
SHEET TITLE:
KA'ULU BY GENTRY II
CPR SET
ENLARGED PARTIAL SITE PLAN
SHEET NUMBER:

S-07

KA'ULU BY GENTRY II

91-1101 FRANKLIN D. ROOSEVELT AVENUE,
KAPOLEI, HAWAII 96707

- TRASH PICK UP LOCATION FOR UNIT 271 OF PHASE 13*
- TRASH PICK UP LOCATION FOR UNIT 272 OF PHASE 13*
- TRASH PICK UP LOCATION FOR UNIT 273 OF PHASE 13*
- TRASH PICK UP LOCATION FOR UNIT 274 OF PHASE 13*
- TRASH PICK UP LOCATION FOR UNIT 275 OF PHASE 13*
- TRASH PICK UP LOCATION FOR UNIT 276 OF PHASE 13*
- TRASH PICK UP LOCATION FOR UNIT 277 OF PHASE 13*
- TRASH PICK UP LOCATION FOR UNIT 278 OF PHASE 13*

(FUTURE)
KA'ULU BY GENTRY III,
PHASE 15

(FUTURE)
KA'ULU BY GENTRY III,
PHASE 14

LEGEND:

- APPROX. LIMIT OF PRIVATE AREA (LIMITED COMMON ELEMENT)
- APPROXIMATE LIMIT OF ASSOCIATION LANDSCAPING (COMMON ELEMENT)
- APPROXIMATE LOCATION OF CONC. DRIVEWAY, WALKWAY, & PARKING (COMMON ELEMENT)
- MULTI-FAMILY BUILDING (LIMITED COMMON ELEMENT)
- ALL PARKING SPACES ARE STANDARD
- PICKET FENCE
- PRIVACY FENCE
- IRRIGATION SLEEVE
- APPROX. ELECTRICAL LINE LOCATION
- APPROX. SEWER LINE LOCATION
- APPROX. WATER LINE LOCATION
- APPROX. ELECT. METER LOCATION
- APPROX. LOCATION OF STREET LIGHT
- AIR CONDITIONING PAD
- TRASH/RECYCLE BIN LOCATION
- DRAIN / DRAIN LINE
- UTILITIES
- 1-HOUR FIRE RATED EXTERIOR WALL

NOTES:

- DIMENSIONS ARE TO EXTERIOR FRAMING UNLESS OTHERWISE NOTED.
- ALL CIVIL IS DIAGRAMMATIC AND STRICTLY FOR REFERENCE PURPOSES.
- WALKWAYS, DRIVEWAYS, PARKING, AND FENCED YARD SIZES, LOCATIONS, AND CONFIGURATIONS MAY VARY DUE TO JOBSITE CONDITIONS.
- ACTUAL LOCATIONS OF UTILITIES, COMMON ELEMENTS, LIMITED COMMON ELEMENTS, FENCES, AND OTHER FEATURES MAY VARY DUE TO ON-SITE CONDITIONS.
- PLAN #R IS REVERSE FLOOR PLAN
- ALL OFF-STREET PARKING SPACES, PARKING LOTS AND DRIVEWAYS SHALL BE PROVIDED AND MAINTAINED WITH AN ALL-WEATHER SURFACE.
- ALL LIMITED COMMON ELEMENT YARD AREAS TO BE LANDSCAPED ACCORDING TO CPR DECLARATION AND PROJECT RULES.
- ALL REQUIRED YARDS SHALL BE LANDSCAPED AND MAINTAINED IN HEALTHY CONDITION.
- THESE PLANS HAVE BEEN DESIGNED IN ACCORDANCE WITH CHAPTER 15-215, HAWAII ADMINISTRATIVE RULES, "KALAELOA COMMUNITY DEVELOPMENT DISTRICT RULES" (2012).
- AS SET FORTH IN THE CONDOMINIUM DECLARATION FOR KA'ULU BY GENTRY II, SUBJECT TO CERTAIN RESTRICTIONS, THE OWNERS AND RESIDENTS OF UNITS 271-278 OF THE KA'ULU BY GENTRY II, PHASE 13 CONDOMINIUM PROJECT SHALL EACH HAVE THE RIGHT TO PLACE THEIR RESPECTIVE TRASH CONTAINERS ON THE PORTION OF THE PROJECT THAT IS DESIGNATED ON KA'ULU BY GENTRY III, PHASE 14 (FUTURE) FOR THE PLACEMENT OF SUCH CONTAINERS, AS WELL AS ACCESS TO SUCH LOCATION.

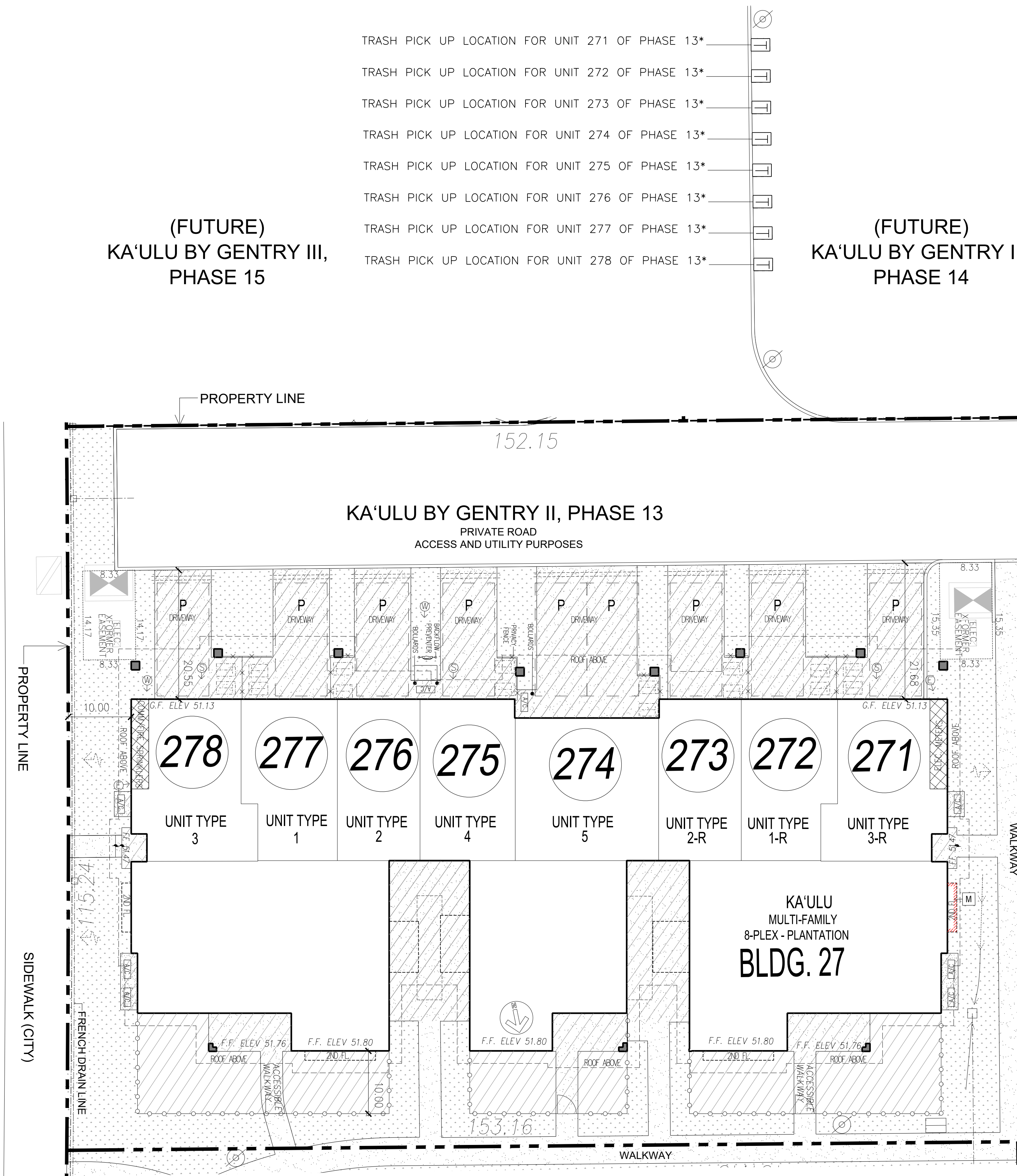

(FUTURE) KA'ULU BY GENTRY II, PHASE 9

COPAHEE AVENUE

PROPERTY LINE

SIDEWALK (CITY)

KA'ULU BY GENTRY II, PHASE 12

KA'ULU BY GENTRY II, PHASE 8

ENLARGED PARTIAL SITE PLAN
PHASE 13

SCALE: 1"=10' (24"x36" SHEET)



1
S-08



THESE DRAWINGS AND ACCOMPANYING SPECIFICATIONS ARE THE PROPERTY OF GENTRY KALAELOA, LLC. NO PART OF THESE DRAWINGS OR SPECIFICATIONS SHALL BE REPRODUCED OR TRANSMITTED IN ANY FORM OR BY ANY MEANS, ELECTRONIC OR MECHANICAL, INCLUDING PHOTOCOPYING, RECORDING, OR BY ANY INFORMATION STORAGE AND RETRIEVAL SYSTEM, WITHOUT THE WRITTEN PERMISSION OF GENTRY KALAELOA, LLC. THESE DRAWINGS AND SPECIFICATIONS ARE TO BE USED ONLY FOR THE PROJECT AND SITE SPECIFICALLY IDENTIFIED HEREIN. ANY REUSE OR MODIFICATION OF THESE DRAWINGS OR SPECIFICATIONS WITHOUT THE WRITTEN PERMISSION OF GENTRY KALAELOA, LLC IS STRICTLY PROHIBITED EXCEPT BY WRITTEN PERMISSION OF GENTRY KALAELOA, LLC. THESE DRAWINGS AND SPECIFICATIONS SHALL REMAIN THE ARCHITECT'S PROPERTY.

DESIGNED BY: JACOB E. KASASIK
CHECKED BY: JACOB E. KASASIK
DATE: 04/30/24

GENTRY KALAELOA, LLC
1555 KAPOLEI AVENUE, SUITE 100
KAPOLEI, HAWAII 96703
(808) 261-1000

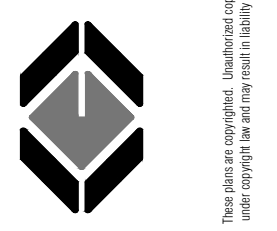

KA'ULU BY GENTRY
BUILDING CPR SET
GENTRY KALAELOA, LLC
HONOLULU, HAWAII

DRAWN BY: JM
CHECKED BY: KS JS
TRACK NO:
ISSUE DATE: 2024-03-01
REVISIONS:

CHAPTER:
SHEET TITLE:
KA'ULU BY GENTRY II
CPR SET
ENLARGED PARTIAL SITE PLAN
SHEET NUMBER:

S-08